

Pontotoc County

Pontotoc County Schools Prelim. Design

Standard
2009

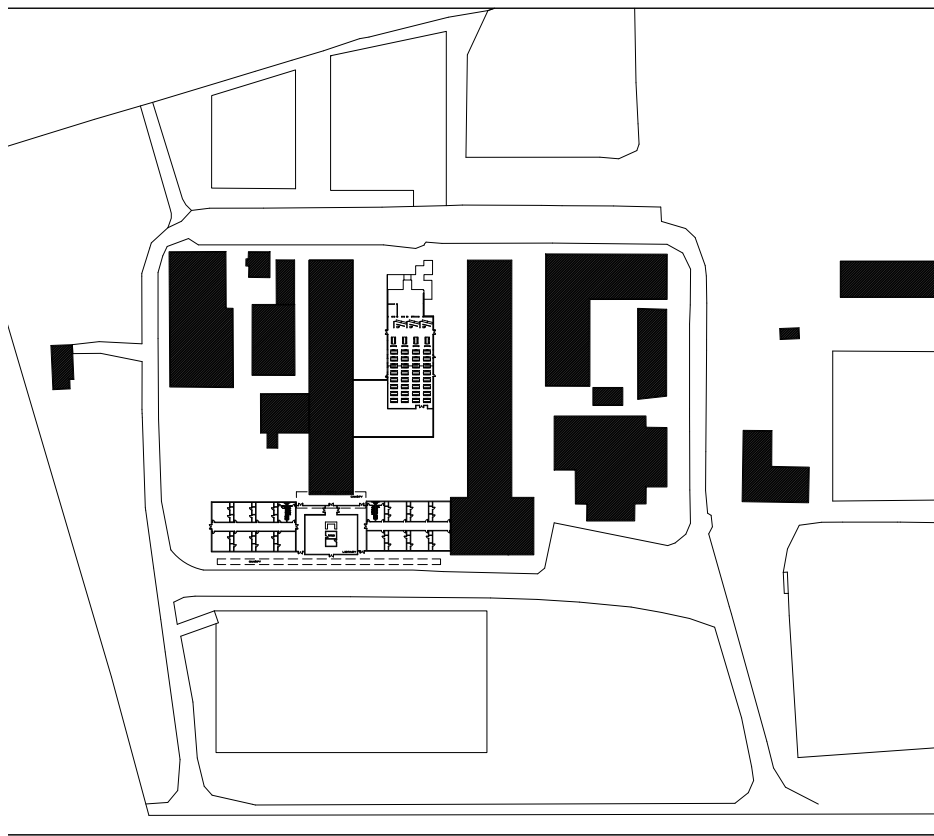
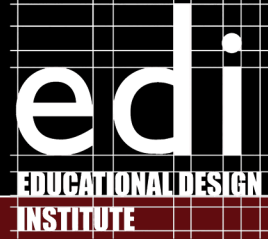

At North Pontotoc High School, EDI was asked to evaluate sites for a classroom addition while making provisions for an expansion of the cafeteria. The final design calls for a new classroom and library addition, which will provide needed classroom space while accommodating the library, which is being relocated to make room for an expanded dining room.

The EDI design accomplishes several goals: 1) The cafeteria expansion is achieved with minimal disruption and expense, 2) The library is relocated to the front and center of the school, emphasizing its importance, and 3) The location of the proposed addition maintains the integrity of the campus while providing an opportunity to improve the appearance of the school from the highway.

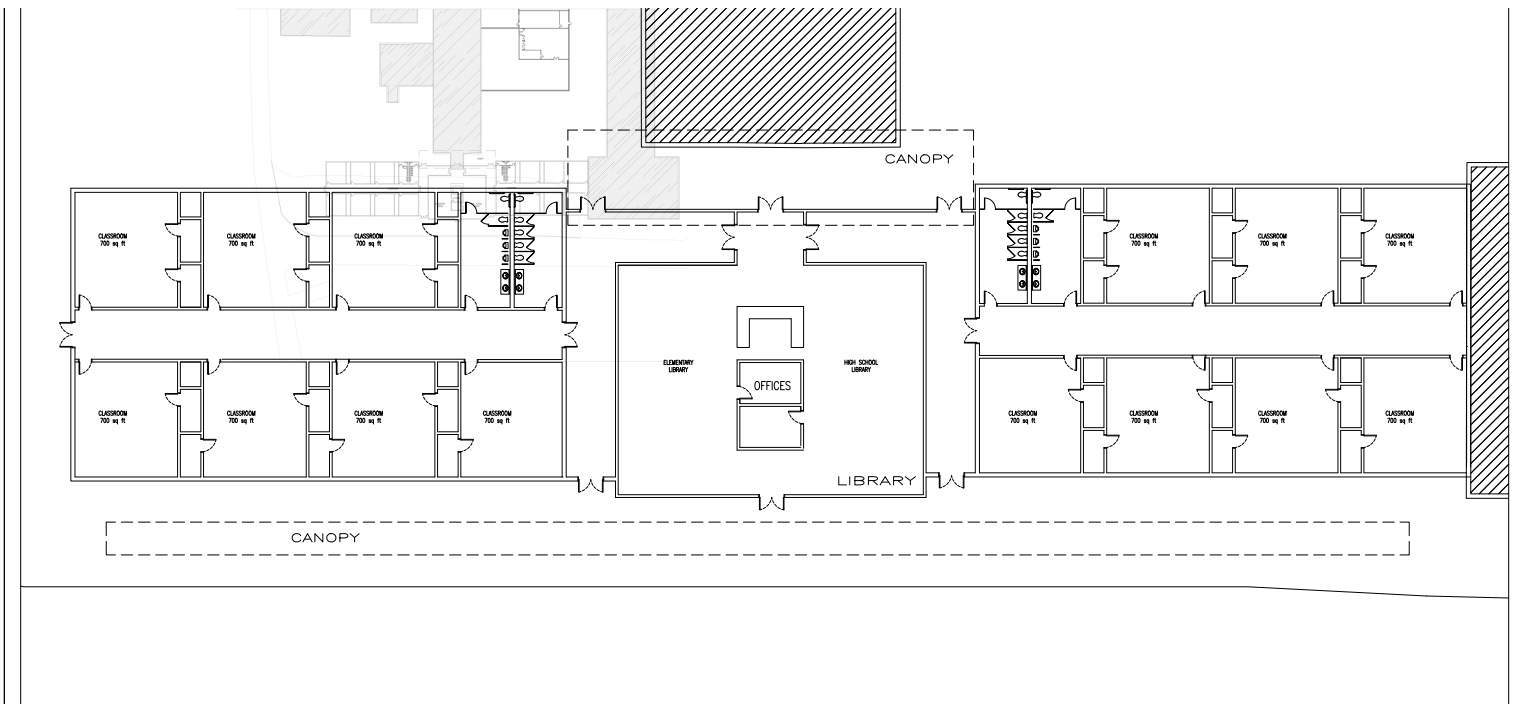

Educational Design Institute

Giles Hall - #106
Mississippi State University
P.O. Box AQ, MS 39762

Phone: (662) 325 - 9225
Fax: (662) 325 - 8872
www.edi.msstate.edu



